



LEGEND

	ASPHALT PAVEMENT
	PERVIOUS PAVERS
	STAMPED CONCRETE
	STAMPED CONCRETE
	STAMPED CONCRETE
	STAMPED CONCRETE
	STAMPED CONCRETE
	STAMPED CONCRETE
	STAMPED CONCRETE
	EXISTING CONCRETE SIDEWALK

BOHLER ENGINEERING

CIVIL & CONSULTING ENGINEERS
 SURVEYORS
 PROJECT MANAGERS
 ENVIRONMENTAL CONSULTANTS
 LANDSCAPE ARCHITECTS

OFFICES:
 WASHINGTON, DC
 ALABAMA, MOBILE, AL
 ARIZONA, PHOENIX, AZ
 CALIFORNIA, SAN FRANCISCO, CA
 FLORIDA, TAMPA, FL
 GEORGIA, ATLANTA, GA
 ILLINOIS, CHICAGO, IL
 INDIANA, INDIANAPOLIS, IN
 IOWA, DES MOINES, IA
 KANSAS, WICHITA, KS
 MARYLAND, BALTIMORE, MD
 MASSACHUSETTS, BOSTON, MA
 MICHIGAN, LANSING, MI
 MINNESOTA, MINNEAPOLIS, MN
 MISSISSIPPI, JACKSON, MS
 MISSOURI, KANSAS CITY, MO
 NEBRASKA, OMAHA, NE
 NEVADA, LAS VEGAS, NV
 NEW YORK, NEW YORK, NY
 NORTH CAROLINA, RALEIGH, NC
 NORTH DAKOTA, GRAND FORK, ND
 OHIO, COLUMBUS, OH
 OKLAHOMA, OKLAHOMA CITY, OK
 PENNSYLVANIA, PHILADELPHIA, PA
 SOUTH CAROLINA, COLUMBIA, SC
 SOUTH DAKOTA, SIOUX FALLS, SD
 TEXAS, HOUSTON, TX
 UTAH, SALT LAKE CITY, UT
 VIRGINIA, RICHMOND, VA
 WISCONSIN, MILWAUKEE, WI
 WYOMING, CHEYENNE, WY

REGISTERED PROFESSIONAL ENGINEER
 LICENSE NO. 28667 (EXPIRATION DATE: 6/30/21)

REVISIONS

REV	DATE	COMMENT	BY

NOT APPROVED FOR CONSTRUCTION

THE FOLLOWING STATE REQUIREMENT NOTIFICATION BY PROFESSIONAL ENGINEERS, DESIGNERS, OR ANY PERSON PROVIDING SUCH SERVICES TO THE STATE OF MARYLAND, APPLICABLE TO ANY PROJECT WITHIN THE STATE OF MARYLAND, IS HEREBY FORWARDED TO YOU BY THE STATE OF MARYLAND. ANY VIOLATION OF THIS NOTIFICATION IS A VIOLATION OF THE PROFESSIONAL ENGINEERING ACT, TITLE 8-101, SUBTITLE 101, CHAPTER 101.01, AND 101.02 OF THE MARYLAND CODE.

FINAL SITE PLAN

FOR
KIMCO REALTY CORPORATION
 LOCATION OF SITE
WILDE LAKE VILLAGE CENTER
 COLUMBIA, MD

BOHLER ENGINEERING

901 DULANEY VALLEY ROAD, SUITE 801
 TOWSON, MARYLAND 21284
 Phone: (410) 821-7900
 Fax: (410) 821-7987
 www.BohlerEngineering.com

M.T. ALLEN

PROFESSIONAL ENGINEER
 MARYLAND LICENSE NO. 81387

SHEET TITLE
FINAL SITE PLAN

SHEET NUMBER
1
 OF 5

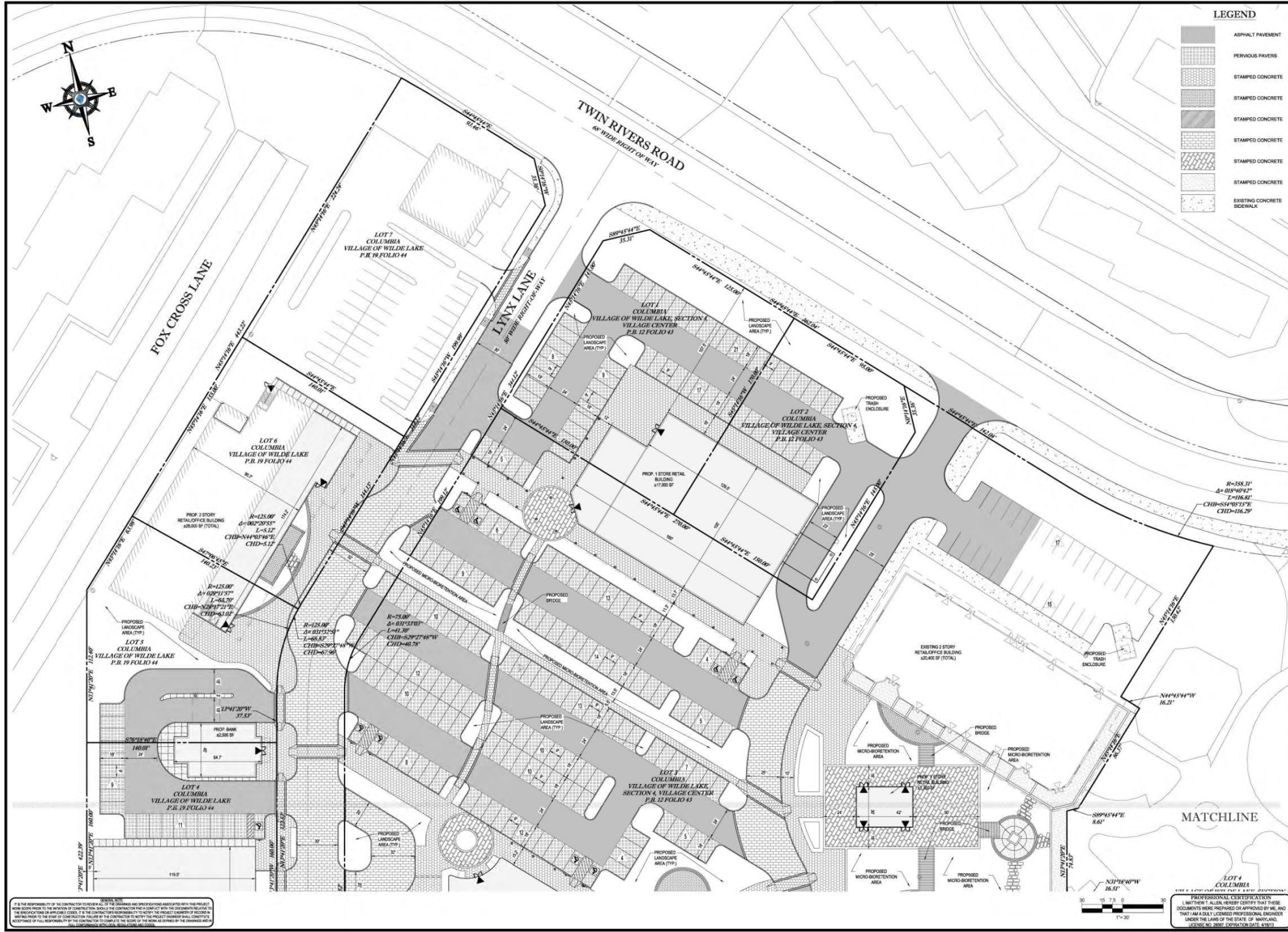

IT IS THE RESPONSIBILITY OF THE CONTRACTOR TO VERIFY ALL OF THE DIMENSIONS AND SPECIFICATIONS ASSOCIATED WITH THIS PROJECT. ANY DISCREPANCIES SHOULD BE REPORTED TO THE ARCHITECT IMMEDIATELY UPON DISCOVERY. THE CONTRACTOR SHALL BE RESPONSIBLE FOR OBTAINING ALL NECESSARY PERMITS AND APPROVALS FROM THE APPROPRIATE AGENCIES. THE CONTRACTOR SHALL BE RESPONSIBLE FOR OBTAINING ALL NECESSARY PERMITS AND APPROVALS FROM THE APPROPRIATE AGENCIES. THE CONTRACTOR SHALL BE RESPONSIBLE FOR OBTAINING ALL NECESSARY PERMITS AND APPROVALS FROM THE APPROPRIATE AGENCIES.

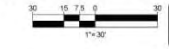

PROFESSIONAL CERTIFICATION
 I, MATTHEW T. ALLEN, HEREBY CERTIFY THAT THESE DOCUMENTS WERE PREPARED OR APPROVED BY ME, AND THAT I AM A DULY LICENSED PROFESSIONAL ENGINEER UNDER THE LAWS OF THE STATE OF MARYLAND. LICENSE NO. 28667 (EXPIRATION DATE: 6/30/21)